

THERMACUT® REPLACEMENT PARTS SUITABLE FOR
Hypertherm®
PAC®500 | MODEL 500®

Up to 600A

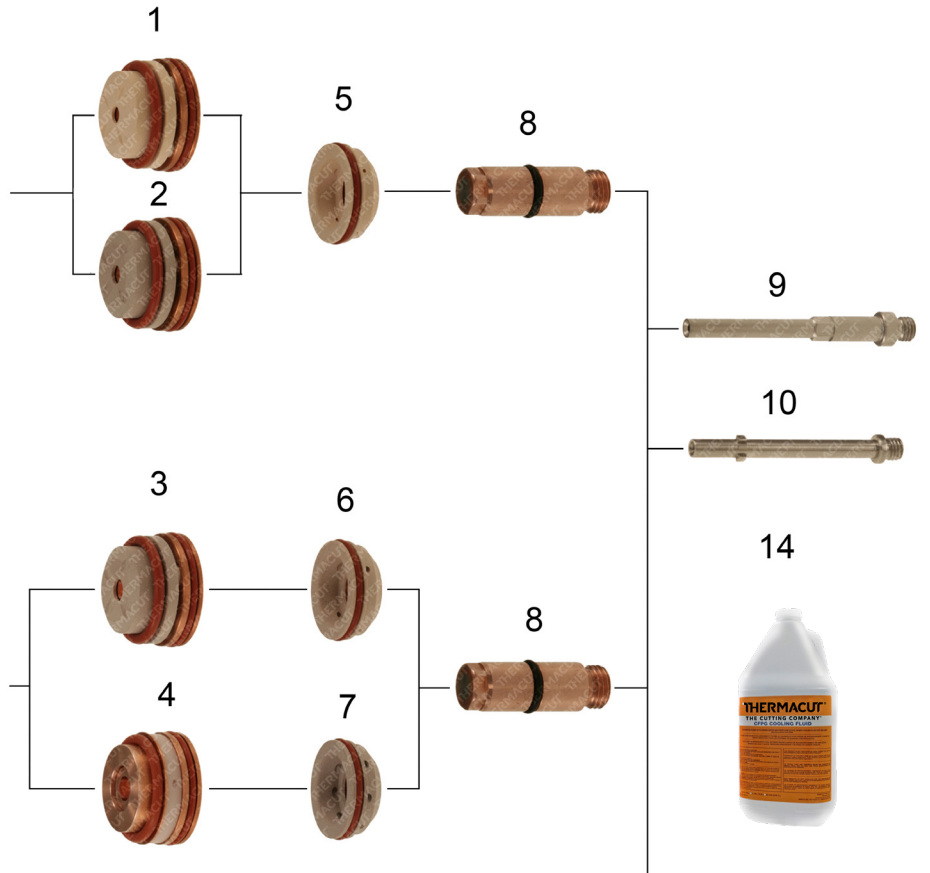

| Item | Part No. | Ref. No. | Description | Std. Pkg | Item | Part No. | Ref. No. | Description | Std. Pkg |
|------|----------|-----------|---|----------|---------|----------|-----------------|---|----------|
| 1. | T-0017 | 020036 | Nozzle .187 | 1 | NS | KT-1157 | 028141 | HT®400, PAC®500 Cable Leads 9.2m (30') | 1 |
| 2. | T-0018 | 020037 | Nozzle .220 | 1 | NS | KT-1153 | 028142 | HT®400, PAC®500 Cable Leads 10.7m (35') | 1 |
| 3. | T-0020 | 020039 | Swirl Ring .120/.166/.187, N ₂ | 1 | NS | KT-1404 | 028143 | HT®400, PAC®500 Cable Leads 12.2m (40') | 1 |
| 4. | T-0021 | 020042 | Swirl Ring .166, .187, CCW | 1 | NS | KT-1217 | K.HT400.15,2M.K | HT®400, PAC®500 Cable Leads 15.2m (50') | 1 |
| 5. | T-0022 | 020040 | Swirl Ring .220 | 1 | NS | KT-1471 | K.PAC500.6,1M | PAC®500 Mach. Torch with Leads 6.1m (20') | |
| | T-0023 | 020048 | Swirl Ring .250 | 1 | NS | KT-1165 | K.PAC500.15,2M | PAC®500 Mach. Torch with Leads 15.2m (50') | 1 |
| 6. | T-0024 | 020038 | Electrode | 5 | NS | KT-1164 | K.PAC500.22,9M | PAC®500 Mach. Torch with Leads 22.9m (75') | 1 |
| **7. | T-1395** | 120035-UR | Water Tube, TMT Torch | 1 | 14. | | | Coolant Liquid. Details on the Accessories page. | |
| 8. | T-0025 | 020030 | Torch Main Body PAC®500 | 1 | 11.-12. | | | Not available any more – OEM only. | |
| 9. | T-1397 | T-1397 | Wrench for TMT Water Tube | 1 | | | | Different types of cable leads available on request | |
| NS | KT-1214 | 028139 | HT®400, PAC®500 Cable Leads 6.1m (20') | 1 | | | | | |
| NS | KT-1154 | 028140 | HT®400, PAC®500 Cable Leads 7.6m (25') | 1 | | | | | |

COMPATIBLE WITH OEM TORCH ONLY, DOESN'T FIT TO THERMACUT® TORCH

** COMPATIBLE WITH THERMACUT® AND OEM TORCH

NS NOT SHOWN IN THE PICTURE

THERMACUT®, FHT-EX® AND EX-TRAFIRE® ARE REGISTERED TRADEMARKS OF THERMACUT, K. S. AND MAY BE REGISTERED IN CZECH REPUBLIC AND/OR OTHER COUNTRIES. ALL OTHER TRADEMARKS ARE PROPERTIES OF THEIR RESPECTIVE OWNERS. THERMACUT IS NO WAY AFFILIATED WITH HYPERTHERM®. MOST THERMACUT PARTS ARE MADE FOR OR BY AN IBG COMPANY. PARTS INDICATED WITH A OEM ARE ORIGINAL PARTS MANUFACTURED BY THE ABOVE NAMED MANUFACTURER AND ARE BEING RESOLD BY THERMACUT. THERMACUT RESERVES THE RIGHT TO SUBSTITUTE OEM PARTS IN PLACE OF THERMACUT PARTS. VALID FROM FEBRUARY 2023 • PREVIOUS VERSION IS NO LONGER VALID. • © COPYRIGHT 2023 BY THERMACUT® CZECH REPUBLIC. ALL RIGHTS RESERVED.